

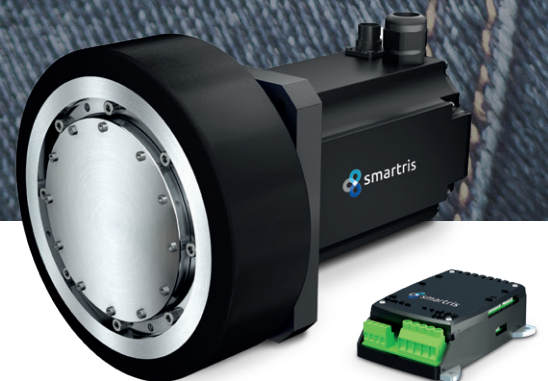

# Smaller is smarter

**Give space to your needs.**

New super-compact drive:  
as small as your smartphone,  
as big as you need.



Shaping the future  
together



Sumitomo Drive Technologies  
LAFERTGROUP

## Smaller is smarter

The new Smartris Drive Compact series has been developed to meet the increasing market demand for compact devices inside battery powered vehicles.

Suitable for supplying the full Smartris ECO-S size, **the new Smartris Drive Compact is only a quarter of the size of the previous drive design.**

Smaller is smarter: the new Smartris Drive Compact maintains the same functionality, with the added advantage of being a plug & play solution for our customers in their most compact vehicles.

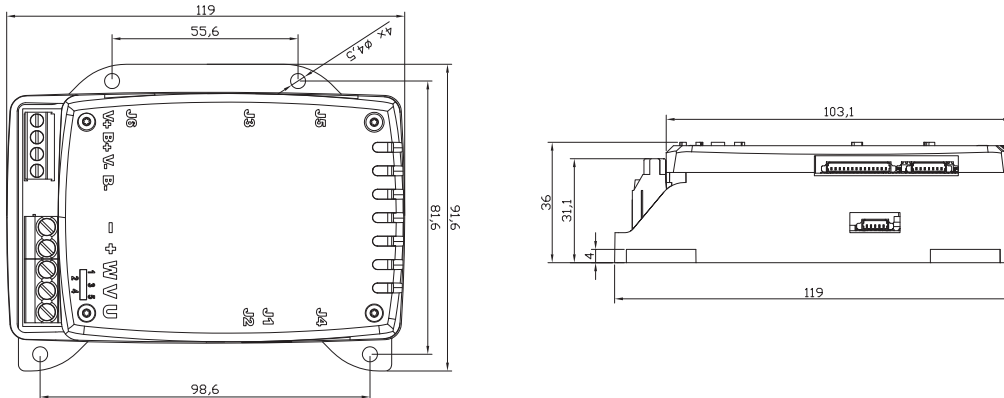

Drive	ECO SMALL	
Voltage	[Arms]	48V (60V Max)
Rated Current	[Arms]	12.5
Peak Current for 2 sec	[Arms]	41
Peak Current for 10 sec	[Arms]	24.9
Transducer	Sin/Cos Encoder - Resolver	
Fieldbus	CanOpen (DS402), ModBus RTU (RS485)	
Control Mode	Torque, Speed and Position	
Brake Management	Manual or Automatic	
Auxiliary power supply for control stage	Available (24 or 48 Vdc)	
Digital Output	4 Output Optical Isolated @ 24V - 100mA	
Digital Input	4 Input Optical Isolated @ 24V - 7mA (NPN or PNP type)	
Analog Input	1 Input $\pm 10V$ or Single ended 0-10V (10 K $\Omega$ )	
Analog Output	1 Output 0-10V R <sub>LOAD</sub> $\geq 1$ K $\Omega$	
Safety Feature	STO (24V typical - 29 mA) certified according to IEC 61800-5-2	
Options	Heatsink	
Protection	IP20	
Certification	CE - UL	
Weight	[g]	310

